

## SAE WHOLE STRAIGHT FLANGE 3000 PSI SERIES - SAE J518

Code: **8050..**  
Type: **SFL**

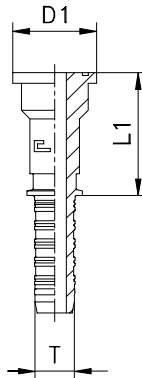

CODE	I.D. hose T			Ø flange	D1	L1	PN [bar]
	DN	size	INCH				
805001	12	-8	1/2	1/2	30	44,5	350
805002	12	-8	1/2	3/4	38	49	350
805003	16	-10	5/8	3/4	38	49,5	350
805004	19	-12	3/4	3/4	38	50	350
805005	19	-12	3/4	1	44,5	53	350
805006	25	-16	1	1	44,5	53,5	280
805007	25	-16	1	1 1/4	50,8	58	280
805008	31	-20	1 1/4	1 1/4	50,8	59	210
805009	31	-20	1 1/4	1 1/2	60,3	61	210
805010	38	-24	1 1/2	1 1/2	60,3	62	185
805011	38	-24	1 1/2	2	71,4	67	185
805012	51	-32	2	2	71,4	68	165

**Notes:** If you wish to order a fitting in stainless steel, please change the first two digit from **80....** to **81....** .

## SAE WHOLE 90° FLANGE 3000 PSI SERIES - SAE J518

Code: **8051..**  
Type: **SFL90**

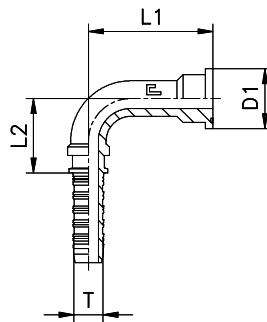

CODE	I.D. hose T			Ø flange	D1	L1	L2	PN [bar]
	DN	size	INCH					
805101	12	-8	1/2	1/2	30	41	36	350
805102	12	-8	1/2	3/4	38	46	36	350
805103	16	-10	5/8	3/4	38	48	40	350
805104	19	-12	3/4	3/4	38	57	47	350
805105	19	-12	3/4	1	44,5	60	47	350
805106	25	-16	1	1	44,5	61	63	280
805107	25	-16	1	1 1/4	50,8	63,5	63	280
805108	31	-20	1 1/4	1 1/4	50,8	74,5	75,5	210
805109	31	-20	1 1/4	1 1/2	60,3	80	75,5	210
805110	38	-24	1 1/2	1 1/2	60,3	90,5	101	185
805111	38	-24	1 1/2	2	71,4	96,5	101	185
805112	51	-32	2	2	71,4	112	137,5	165

**Notes:** If you wish to order a fitting in stainless steel, please change the first two digit from **80....** to **81....** .